

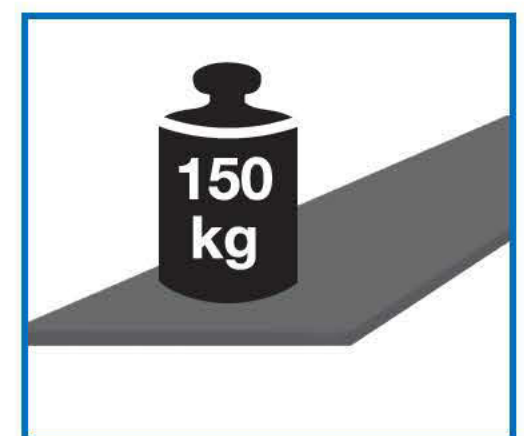

CORDA®

- | | | |
|-------------------------------|-----------------------|----------------------|
| DE Kleingerüst | CZ Malé lešení | IT Ponteggio piccolo |
| GB Small Scaffold | DK Ministillads | NL Kleine steiger |
| PL Mini rusztowanie | EE Väikesed tellingud | NO Liten stillasje |
| RU малые передвижные подмости | ES Pequeño Andamio | RO Schelă mică |
| HU Kisállvány | FI Pienteline | SE Ministällning |
| BA Mala skela | GR Μικρή σκαλωσιά | SI Mali oder |
| BG Малко скеле | HR Mala skela | SK Malé lešenie |
| | | TR Küçük iskele |

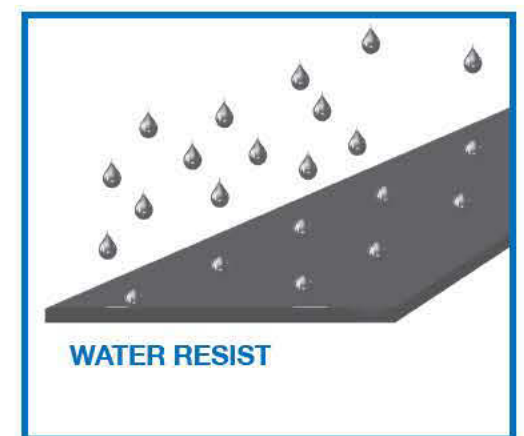

Art.-No. 916174 / 950078

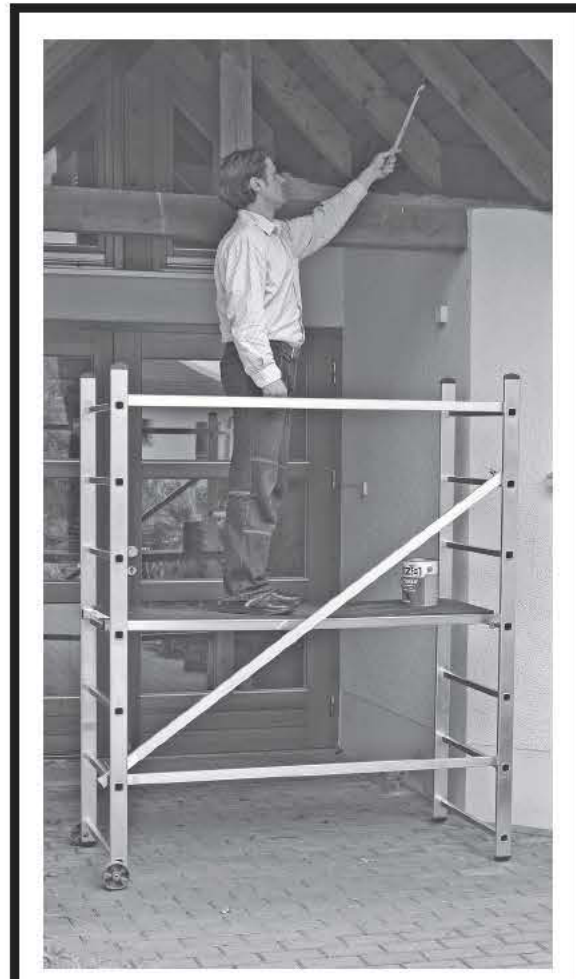
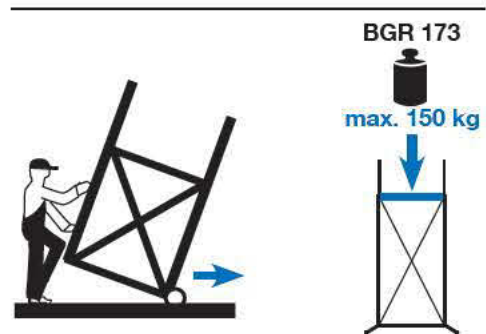
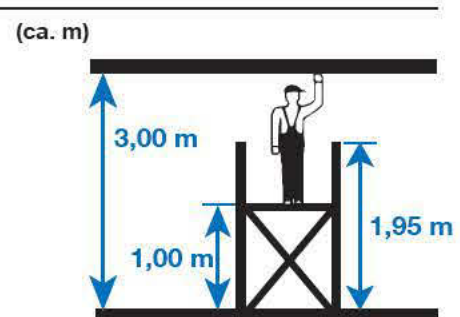

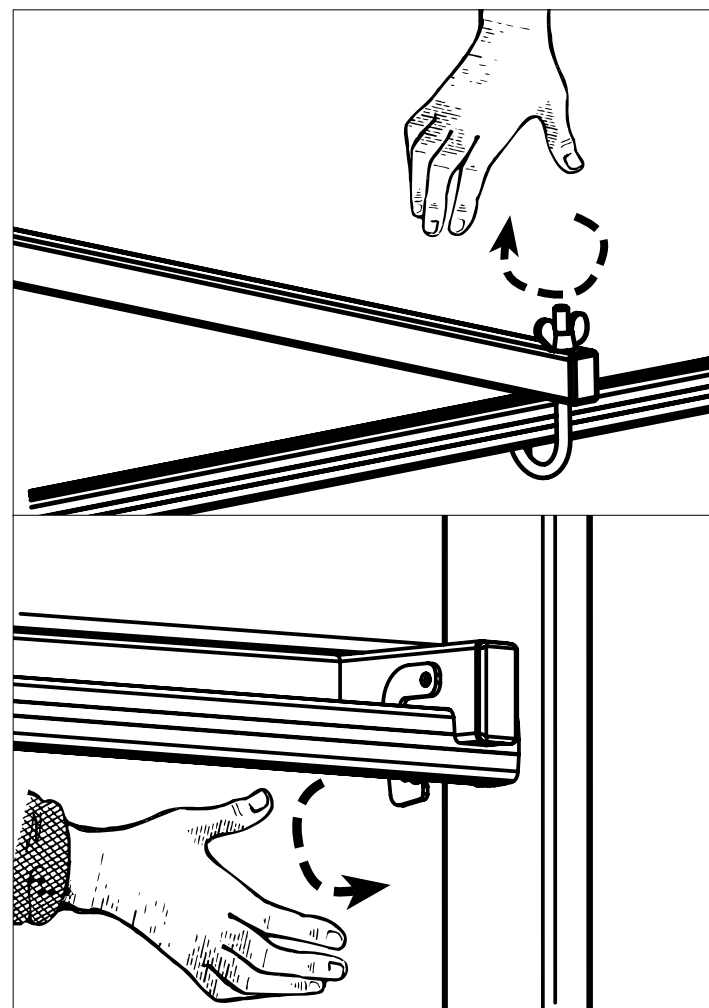
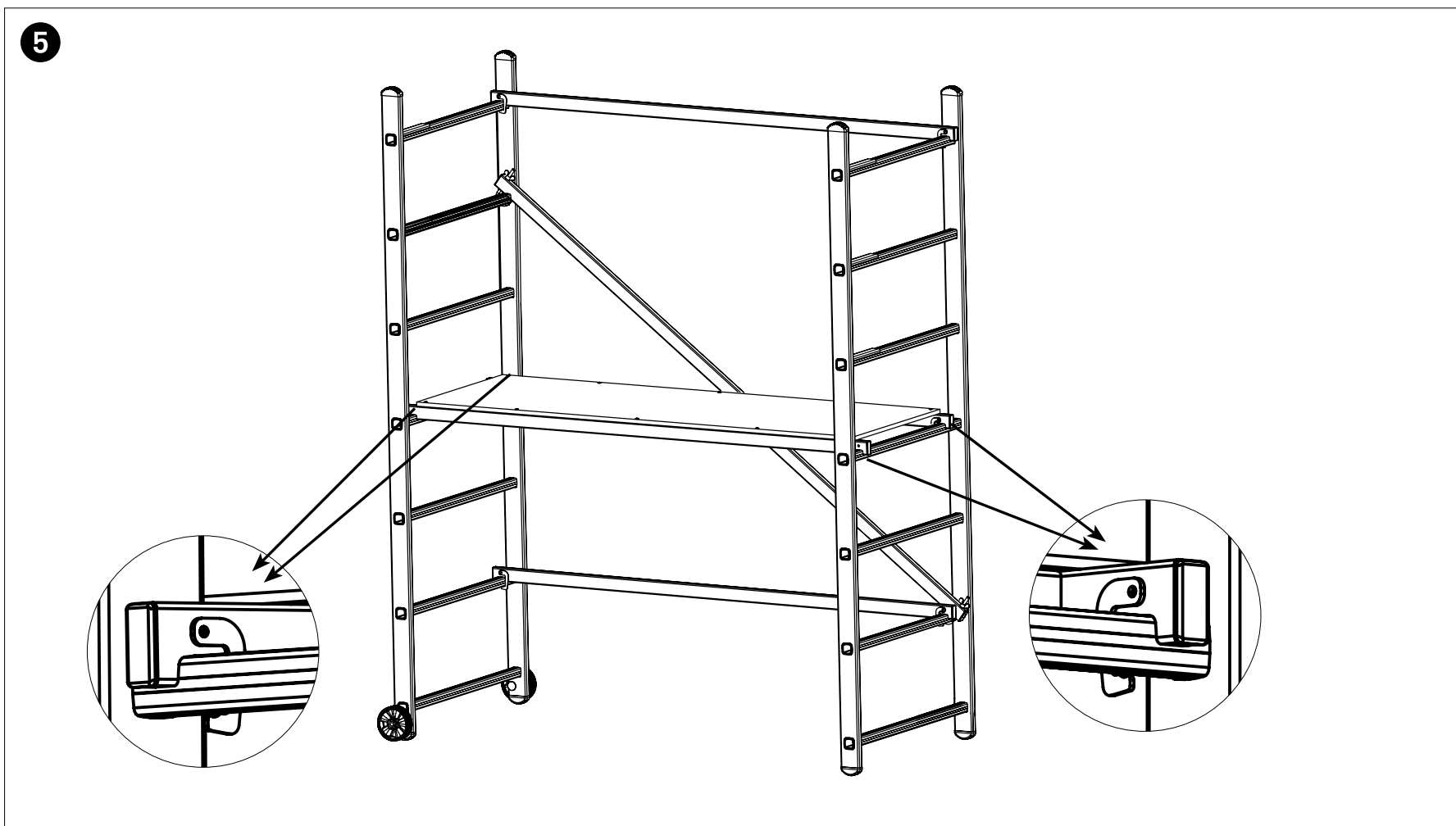
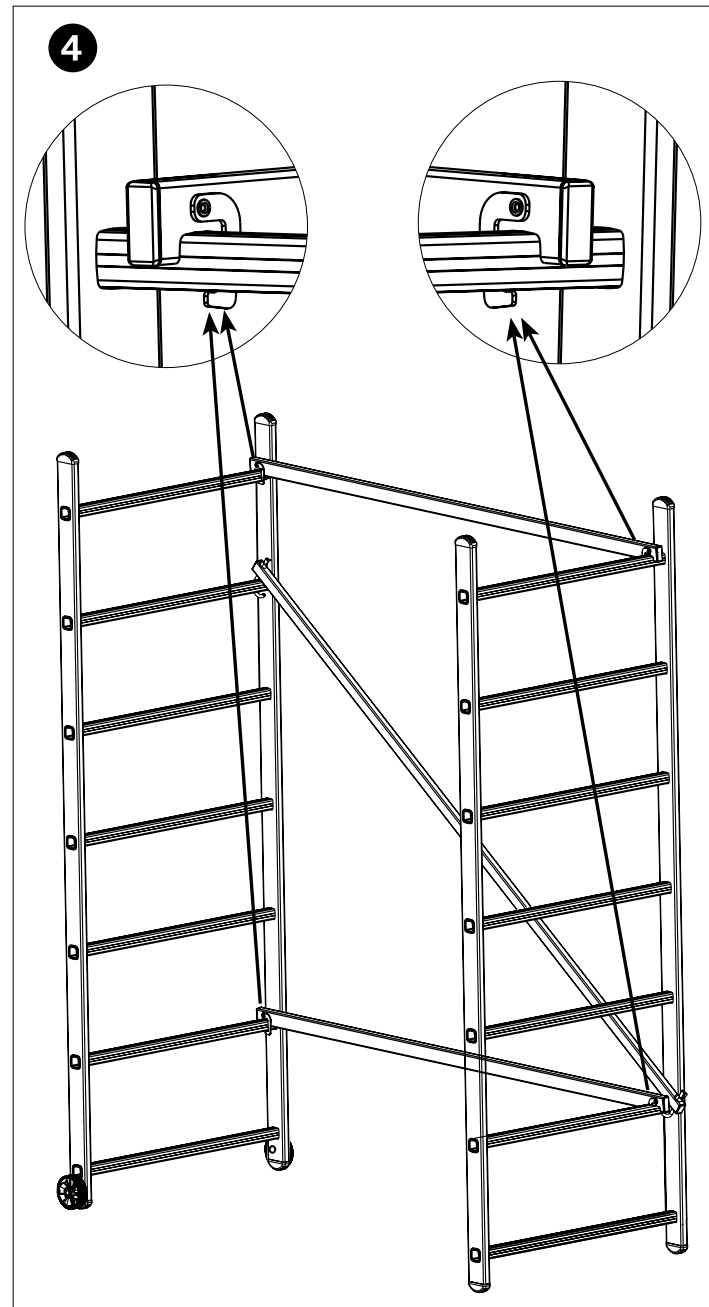
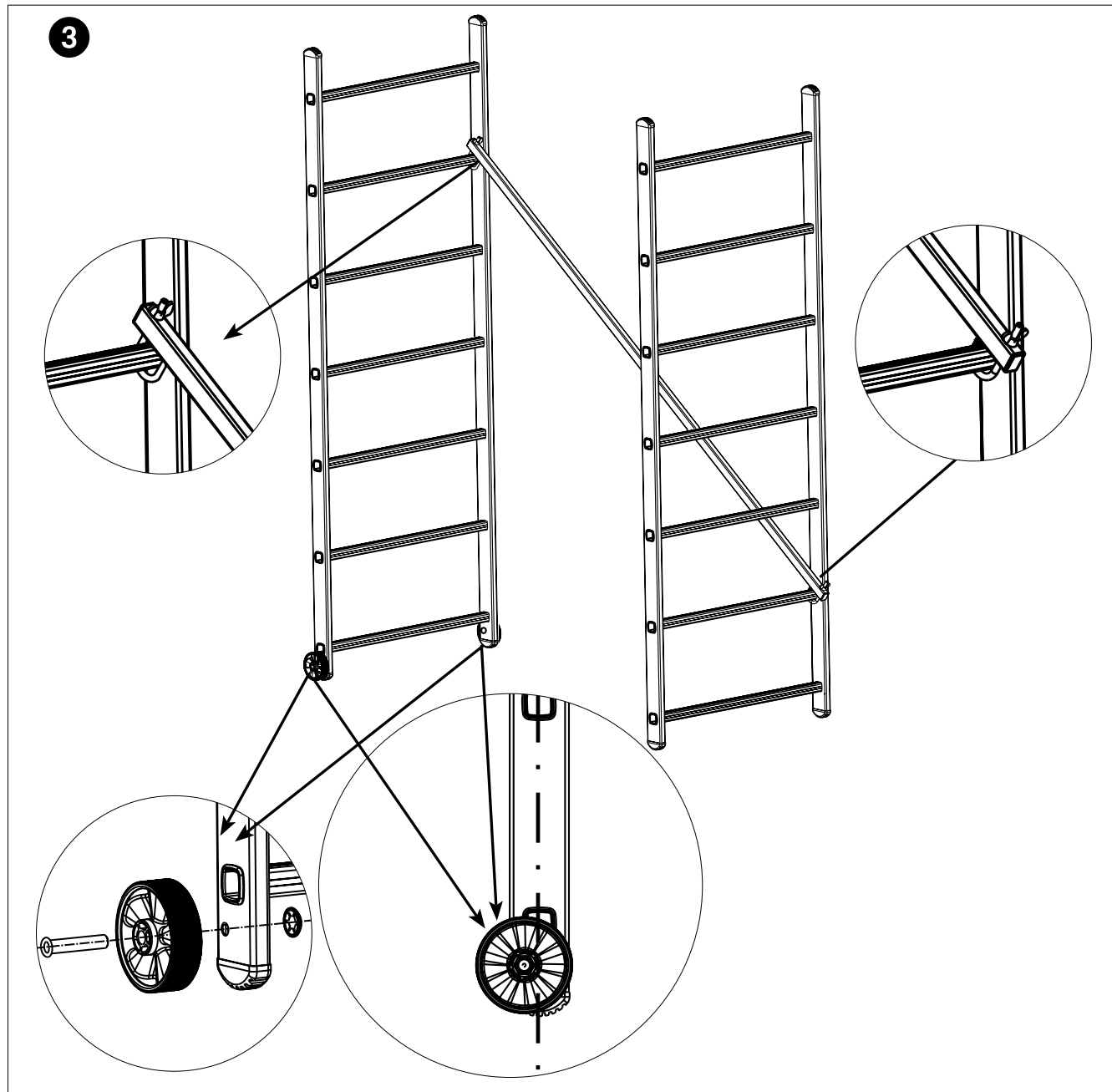
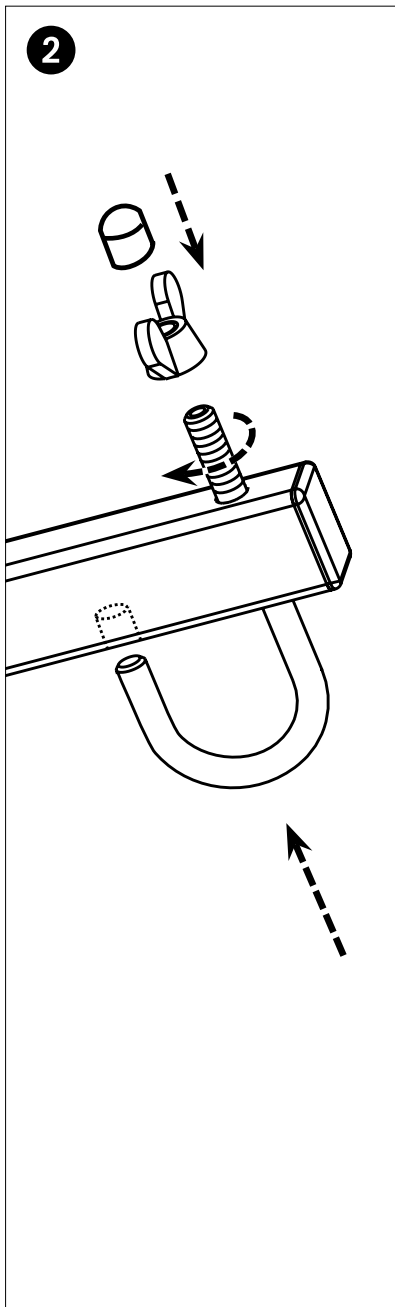
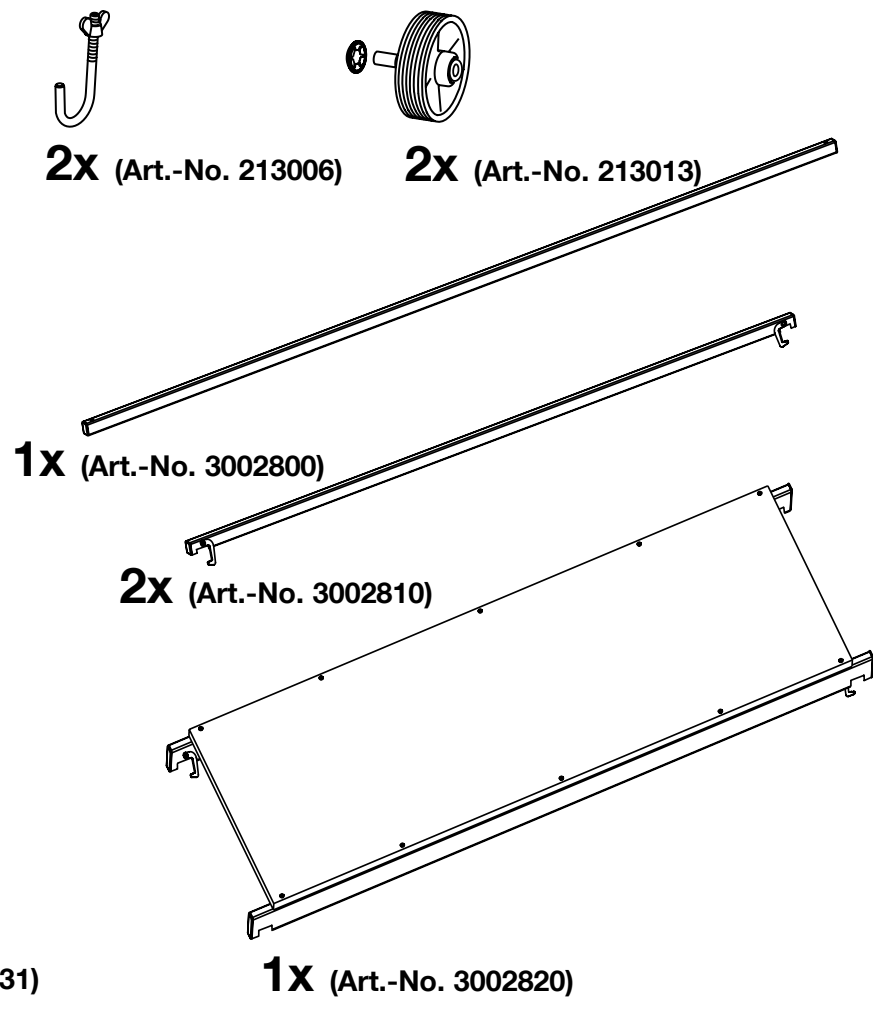
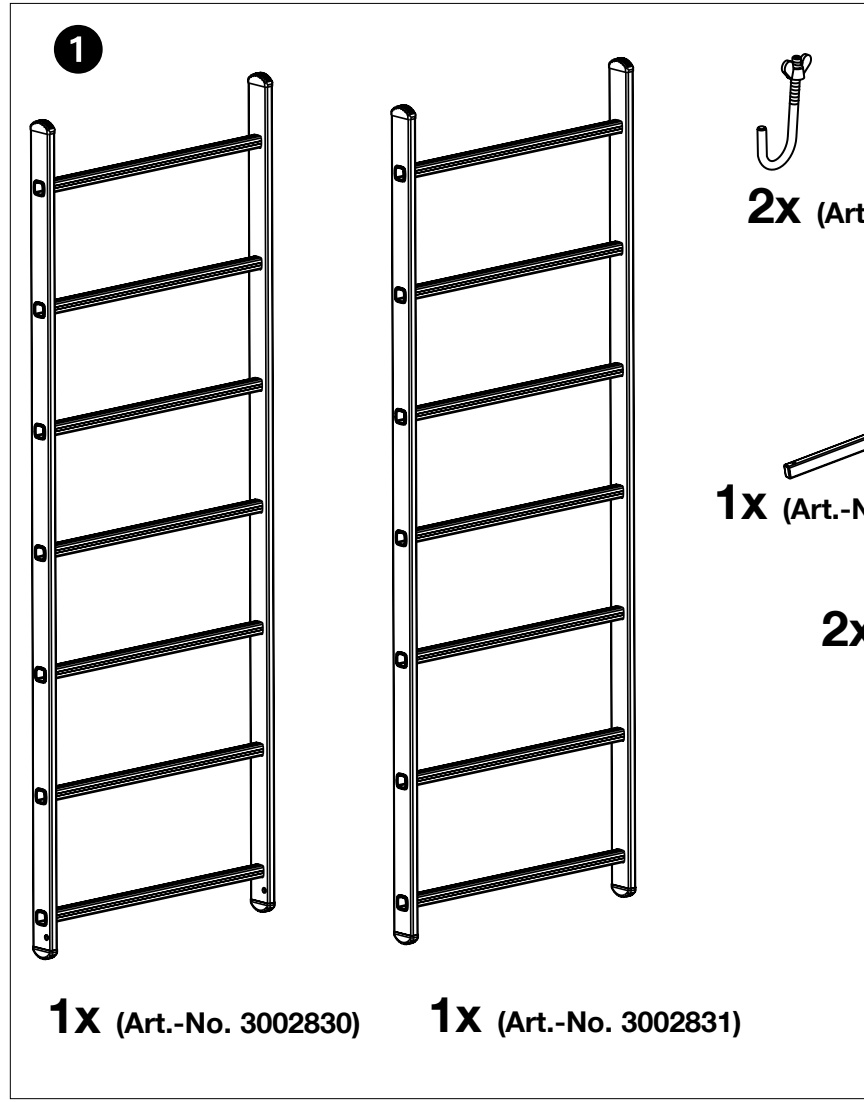
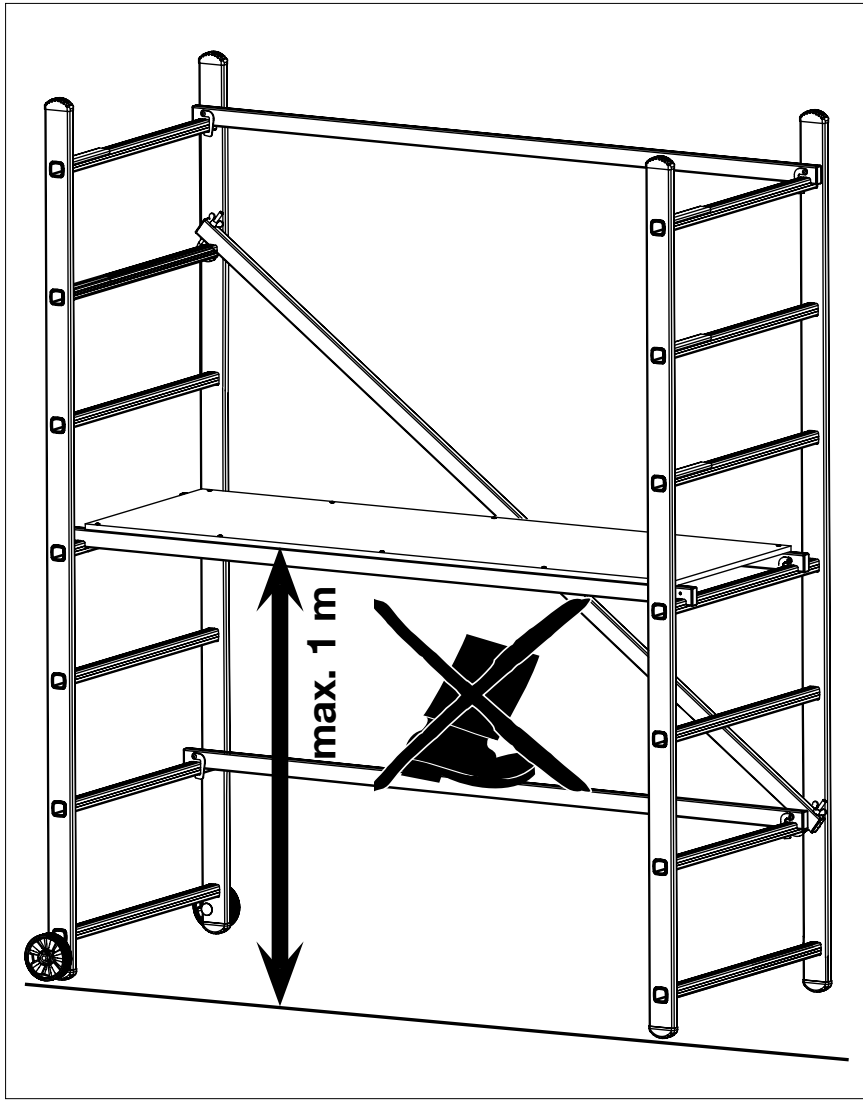

1. Nur original Ersatzteile verwenden.
2. Only use original accessories.
3. Seule utilisation de pièces d'origine.
4. Csak eredeti alkatrészek használhatók.
5. Only original spare parts may be used.
6. Only original accessories may be used.
7. Only original spare parts may be used.
8. Only original accessories may be used.
9. Only original spare parts may be used.
10. Only original accessories may be used.

1. Für unschwerfällige Behandlung wird keine Haftung übernommen.
2. No liability for improper use.
3. Toute utilisation non-conforme n'est effectuée sous garantie.
4. Nem tartunk felelősséget a nem megfelelő használat miatt.
5. No liability for improper use.
6. No liability for improper use.
7. No liability for improper use.
8. No liability for improper use.
9. No liability for improper use.
10. No liability for improper use.

1. Schadhafte Componente sind unverzüglich auszuwechseln.
2. Damaged scaffold parts must be withdrawn from circulation immediately.
3. Si vore article est endommagé, veuillez le plus tôt possible.
4. Sérült alkatrészeket azonnal ki kell vonni a forgalomból.
5. Damaged parts should be replaced immediately.
6. Damaged parts should be replaced immediately.
7. Damaged parts should be replaced immediately.
8. Damaged parts should be replaced immediately.
9. Damaged parts should be replaced immediately.
10. Damaged parts should be replaced immediately.

